

Wireless Router

User Manual

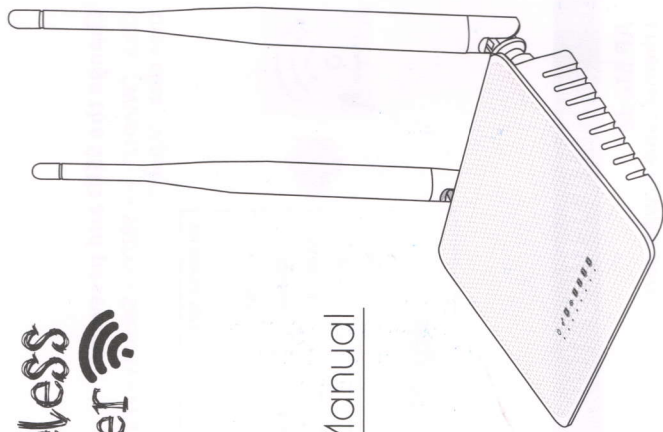

1 Hardware Installation

- ADSL, please comply with step 1, 2, 3 and 4
- Residential Broadband, please comply with step 2, 3 and 4
- Range Extender, please comply with step 3 and 4.

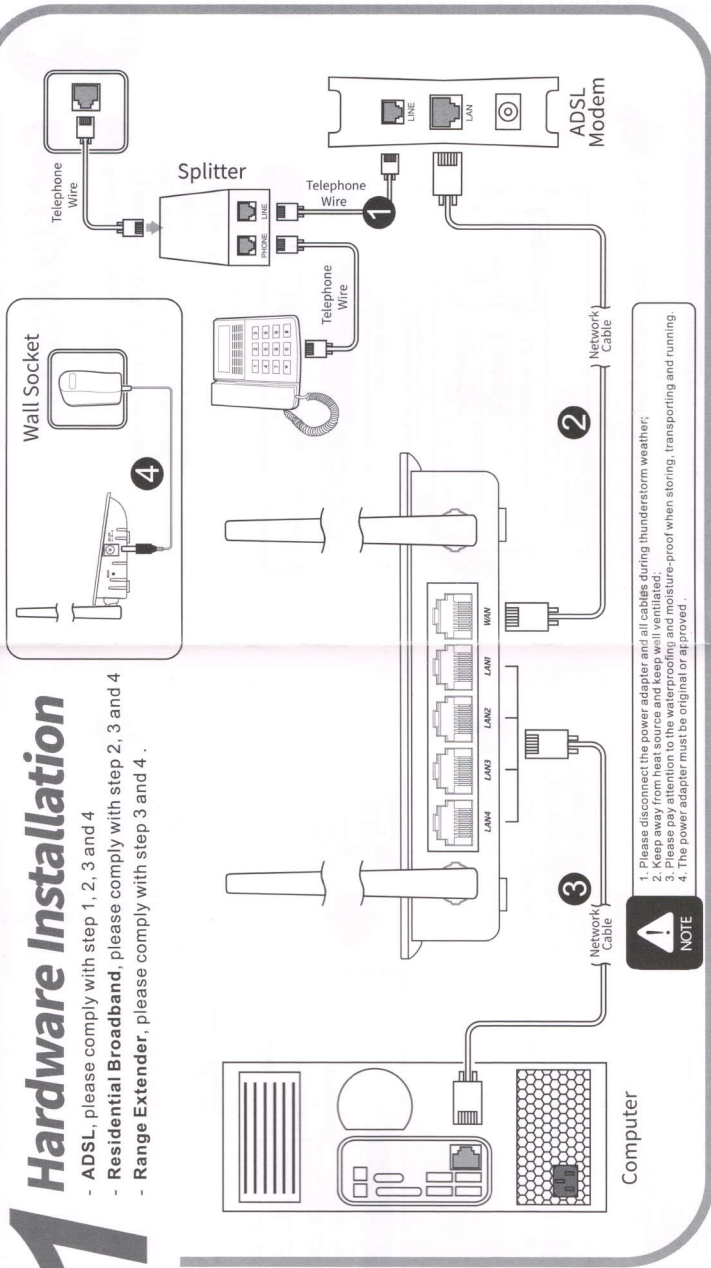

2 Set Up PC

Windows Vista / 7 / 10

- 1 Right-click Computer desktop lower right corner Network connection icon—Open Network and Sharing Center

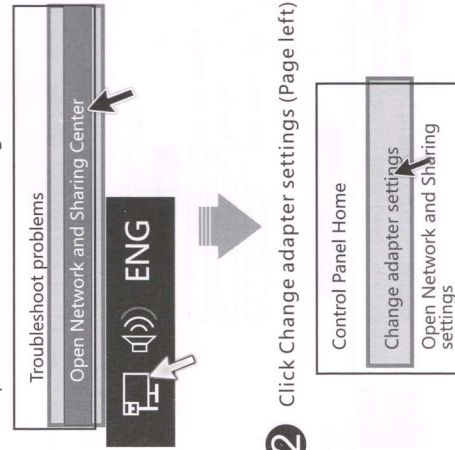

- 2 Click Change adapter settings (Page left)

NOTE

After Extender Mode successfully, if you will find that you cannot get into the router again. That you set up the terminal device (laptop or mobile phone) IP address as fixed IP address: **192.168.1.x** (x cannot be digital 1(2~255)) Default gateway: **192.168.1.1**

- 3 Right-click Local Area Connection, and choose Properties.

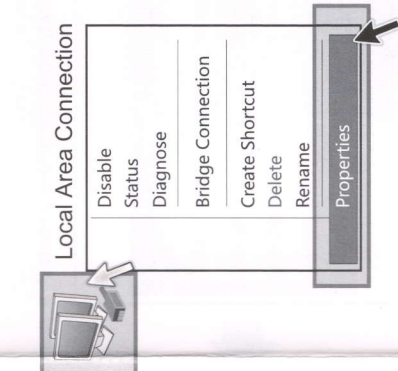

- 4 Double-click Internet Protocol Version 4 (TCP/IPv4).

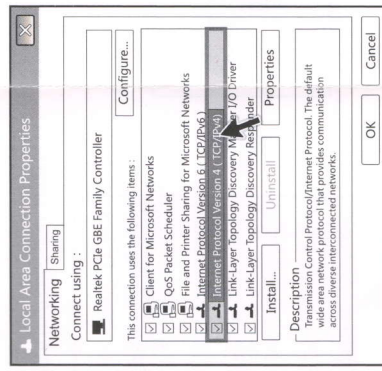

- 5 Choose Obtain an IP address automatically and Obtain DNS server address automatically, click OK; And then click OK.

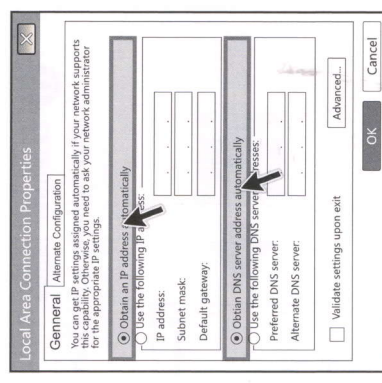

3

Set Up Router

- 1 Run any Web browser.
Type **192.168.1.1** in the web browser, then press Enter key
Enter User Name and Password
user name: admin
password: admin

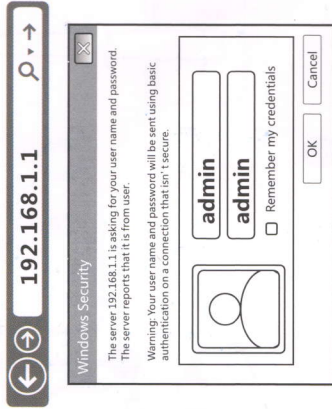

- 2 Now you can see the Easy Setup interface.

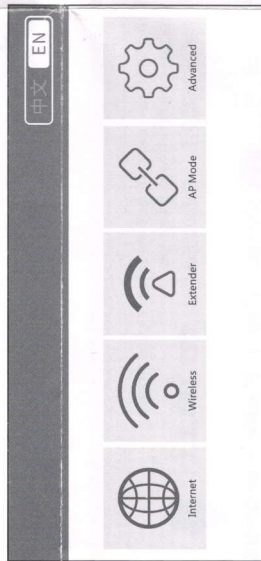

- 6 Extender Mode

Click Extender icon--Scan

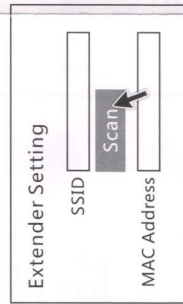

- 3 PPPoE Mode

Click "Internet" >> PPPoE>> User Name>> Password, then click "Apply"

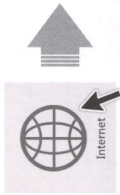
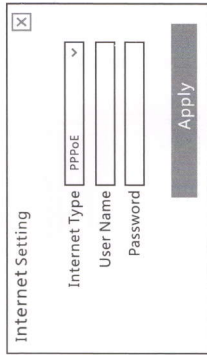

- 4 Static IP Mode

Click "Internet" >> Static IP >> IP Address >> Subnet Mask >> Gateway >> Primary DNS as below, then click "Apply"

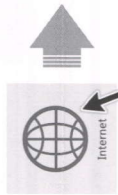
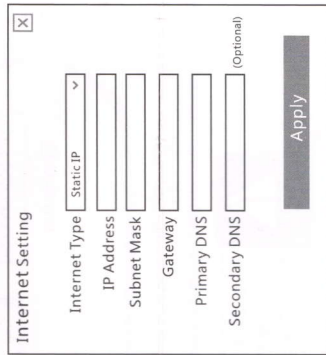

- 5 Change the SSID and password

Click "Wireless" >> SSID>> Security>> Password, then click "Apply"

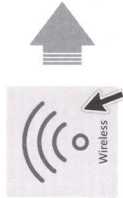
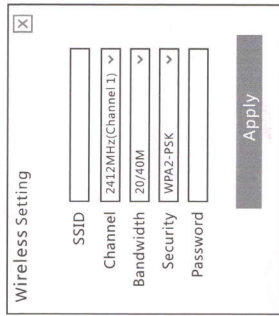

Pattern setting steps

AP Mode

Ethernet cable to WAN port
(make sure the primary router which the other head of Ethernet cable is connected to is available for internet)

Extender Mode (step 1 5 6)

PPPoE Mode (step 1 5 3)

Static IP Mode (step 1 5 4)

Change the SSID and password (step 1 5)

Select the SSID you want to repeat, input the primary router's password then click "Apply", the device will restart automatically.

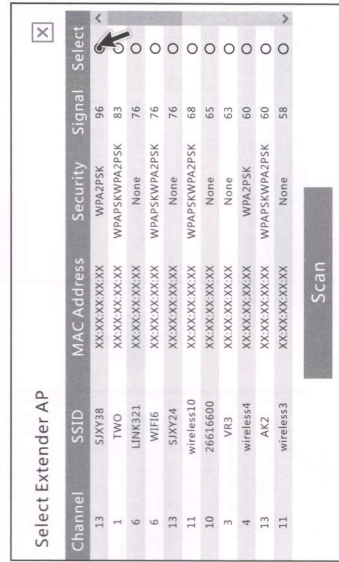

When the wireless extension is successful, the light on the product panel flashes

